

# UNIVERSAL

## Universal Camshaft Pulley Holding Wrench

### 9AT3-A02

- Use to hold camshaft pulley while loosening and tightening cam sprockets center bolt
- Designed with 4 pair groove pins 7, 10, 14, 16mm
- Adjustable swivel jaw both side application for most engine
- Capacity : 40 ~ 140mm (1-1/2" ~ 8-5/8")
- For universal engine, especially O.H.C. overhead cam engines cars

1000 1 / 6



9 PC.



# UNIVERSAL

## Camshaft Sprocket Puller

### 9AT3-A04

- Use to hold and remove the camshaft sprocket without damaging the sprocket
- Use with 3/8" square drive tool or 19mm wrench
- Suitable for most sprockets from Ø60 to Ø100 mm

KT NO.	Capacity mm	1000	1 / 6
9AT3-A04	60~100	1437	1 / 12

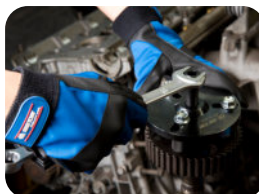

# UNIVERSAL

## Belt Tensioner Lock Pin Set

### 9AT3-B01

- Designed for retaining tensioner plunger in fixed position while replacing timing belt
- Suitable for common vehicle and engine

17 20 / 100

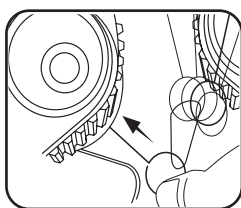

- CONTENTS :
- 0.79mm / .0310"
  - 1.21mm / .0476"
  - 1.41mm / .0560"
  - 1.51mm / .0594"
  - 1.71mm / .0670"
  - 1.92mm / .0760"

# UNIVERSAL

## Dial Test Indicator

### 9AT3-F01

- Use to measure and accurately find the piston TDC position
- This tool has to use with TDC Indicator 9AT3-F02
- It can be used for mechanical circularity, flatness.....etc

63 1 / 100

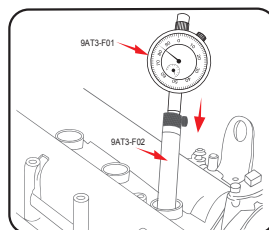

# UNIVERSAL

## TDC Indicator

### 9AT3-F02

- Use to measure if the cylinder piston is at TDC position
- This tool has to use with Dial Test Indicator 9AT3-F01

292 1 / 30

