

BMW

Petrol Engine Timing Alignment Set



9AT1112E

- The set includes camshaft locking tool, VANOS alignment plate, flywheel locking pin
- Suitable for BMW 2.5/3.0 liters chain drive six cylinder, twin cams 16v petrol engines
- Use to lock camshaft in TDC position when setting or adjusting engines timing



12 PC.

5900 1 / 3

MODEL:

128i. E82 (07-08)
 130i. E81/87 (05-08)
 135iS. E82 (07-08)
 323i. E90/91/92/93 (04-08)
 325i/xi. E90/91/92/93 (04-08)
 328i/xi. E90/91/92/93 (04-08)
 330i/xi. E90/91/92/93 (04-08)
 335i/xi. E90/91/92/93 (05-08)
 523i/Li. E60/61 (04-08)
 525i/Li/xi. E60/61 (04-08)
 528i/xi. E60/61 (06-08)
 530i/Li/xi. E60/61 (05-08)
 535i/xi. E60/61 (06-08)
 630i. E63/64 (04-08)
 730i/Li. E65/66 (04-08)
 X3 2.5/3.0 E83 (06-08)
 X5 3.0 E70 (06-08)
 Z4 2.5/3.0 E85/86 (05-08)

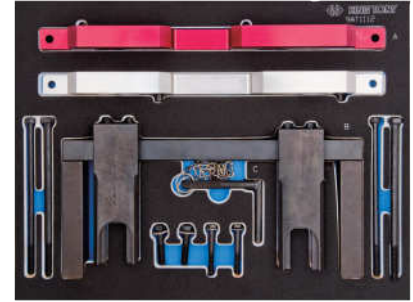
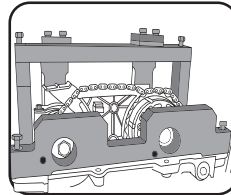
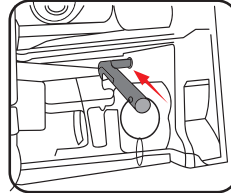

CONTENTS :

- A - VANOS alignment plate (Red for N53/N54, Silver for N51/N52/N52K)
- B - camshaft locking tool
- C - flywheel locking pin

ENGINE CODE: N51 / N52 / N52K (Valvetronic)
 N53 / N54 (Direct Injection)

BMW

Diesel Engine 2.0 / 3.0 Timing Set



9AT2007E

- The set includes camshaft setting plate, tensioner retaining pin set and flywheel locking pin
- Suitable for BMW 2.0 and 3.0 liters common rail diesel engines in BMW 3, 5 & 7 Series, X5, Land Rover Freelander, Range Rover, Rover 75, Vauxhall / Opel
- Use to check and adjust the timing position of camshaft and TDC position of crankshaft



7 PC.

1753 1 / 10

MODEL:

118d E87 (03-07), 120d E87 (03-07)
 318d / td E46 / E90 / 91(00-08)
 320d / td E46 / E90 / 91(97-08)
 325d E90 / 91 / 92 / 93 (06-09)
 330d / xd / cd E46 / E90 / 91 / 92 / 93 (98-08)
 335d E90 / 91 / 92 (06-09)
 520d E39 / E60 / 61 (99-09)
 525d / xd E39 / E60 / 61 (99-09)
 530d / xd E39 / E60 / 61 (98-09)
 535d E60 / 61 (04-09), 635d E63 / 64 (04-09)
 730d / Ld E38 / E65 / 66 (98-08)
 X3 2.0d E83 (03-07), X3 3.0d / sd E83 (03-09)
 X5 3.0d E53 / E70 (00-09)

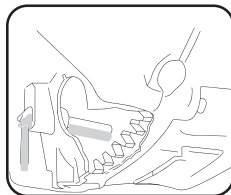
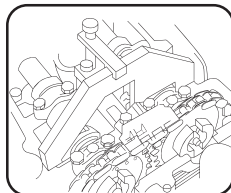

CONTENTS :

- A - camshaft setting plate
- B - camshaft plate locking tool
- C - TDC timing pin
- D - tensioner retaining pin set (pair)
- E - flywheel locking pin

ENGINE CODE: M47 / M57/ M47TU / M57TU / M47T2 / M57T2
 20 4D 1, 20 4D 4, 25 6D 1, 25 6D 2
 30 6D 1, 30 6D 2, 30 6D 3, 30 6D 4
 30 6D 5

ENGINE SERIES



KING TONY

501