

Petrol Engine Timing Alignment Set



9AT1112E

- The set includes camshaft locking tool, VANOS alignment plate, flywheel locking pin
- Suitable for BMW 2.5/3.0 liters chain drive six cylinder, twin cams 16v petrol engines
- Use to lock camshaft in TDC position when setting or adjusting engines timing



5900 1 / 3

MODEL:

128i. E82 (07-08)
 130i. E81/87 (05-08)
 135iS. E82 (07-08)
 323i. E90/91/92/93 (04-08)
 325i/xi. E90/91/92/93 (04-08)
 328i/xi. E90/91/92/93 (04-08)
 330i/xi. E90/91/92/93 (04-08)
 335i/xi. E90/91/92/93 (05-08)
 523i/Li. E60/61 (04-08)
 525i/Li/xi. E60/61 (04-08)
 528i/xi. E60/61 (06-08)
 530i/Li/xi. E60/61 (05-08)
 535i/xi. E60/61 (06-08)
 630i. E63/64 (04-08)
 730i/Li. E65/66 (04-08)
 X3 2.5/3.0 E83 (06-08)
 X5 3.0 E70 (06-08)
 Z4 2.5/3.0 E85/86 (05-08)

ENGINE CODE: N51 / N52 /N52K (Valvetronic)
 N53 / N54 (Direct Injection)

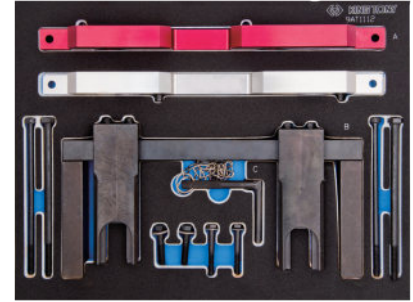
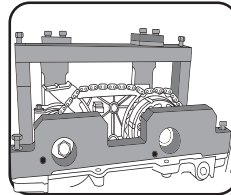
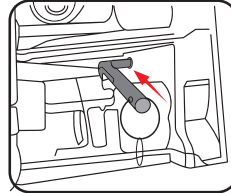

CONTENTS :

- A - VANOS alignment plate (Red for N53/N54, Silver for N51/N52/N52K)
- B - camshaft locking tool
- C - flywheel locking pin

PSA PEUGEOT CITROËN

Petrol Engine Setting & Locking Set – BMW/PSA

9AT1010E

- The set includes camshaft setting tool, crankshaft locking pin & chain tensioner tool
- Suitable for BMW Mini and PSA Peugeot Citroën 1.4/1.6 16v valvetronic direct injection engines
- Use to lock and adjust engine timing



2384 1 / 5

MODEL:

Citroen
 C4(08-11)
 C4 Picasso(08-13)
Peugeot
 207(06-11)
 207CC(07-14)
 308(07-14)
 3008(09-12)
 5008(09-11)

ENGINE CODE:

Citroen
 8FR(EP3)
 5FS(EP6)
Peugeot
 EP3(8FS)
 EP6(5FW)
 EP6DT(5FX)
 8FS(EP3)
 EP6DTS(5FY)

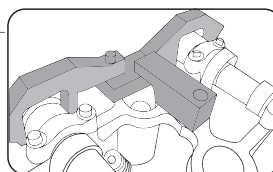

CONTENTS :

- A – camshaft setting tool (inlet)
- B – camshaft setting tool (exhaust)
- C – camshaft setting tool
- D – camshaft setting clamp
- E – crankshaft locking pin
- F – chain tensioner tool
- G – M10 screw*4

