

SAAB

Diesel Engine Setting & locking Set



9AT2005E

- The set includes crankshaft locking tool, camshaft setting tools(pair) and a tensioner locking pin
- Suitable for Saab, Vauxhall / Opel engine
- Use to set and lock engines timing

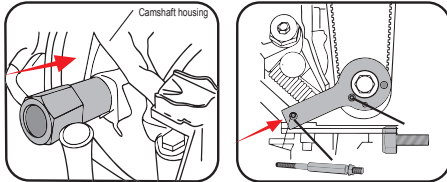

1295 1 / 10

MODEL: Diesel 2.2D T1D
9-3 (98-04), 9-5 (02-06)

ENGINE CODE: Diesel 2.2D T1D
Z19DT / Z19DTH



- CONTENTS :
- A&D - crankshaft locking tools
 - B - camshaft setting tool (pair)
 - C - tensioner locking pin

SUZUKI

Diesel Engine Setting & Locking Set

9AT2004E

- The set includes flywheel locking pin, camshaft setting tools, tensioner locking pin
- Use to retain timing position only. DO NOT use them to hold camshafts in position while releasing or tightening the sprocket bolts

1101 1 / 10

MODEL: Diesel 1.3 DDIS (Belt)
Swift (04-09)
Ignis (03-09)
Wagon R+ (03-08)

ENGINE CODE: Diesel 1.3 DDIS (Belt)
Z13DT

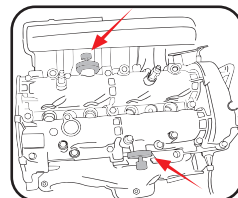
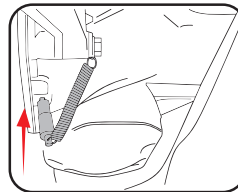

- CONTENTS :
- A- camshaft setting tool set (pair)
 - B- flywheel locking pin
 - C- tensioner retaining pin

VOLKSWAGEN GROUP AUDI/SKODA/VW/SEAT

Petrol Engine Twin Camshaft Setting & Locking Set - VAG 1.4 / 1.6 FSi (Chain)

9AT1103E

- The set includes camshaft setting plate, TDC position tool (with DTI) and tensioner locking pin
- 9AT1103 'B' TDC positioning tool has to use with 9AT3-F01(not included in this set)

1456 1 / 10

MODEL: Audi
A3 (03-07)
Volkswagen
Polo (02-08), Golf V (03-08), Golf Plus (05-08)
Jetta (06-08), Passat (05-08), Touran (03-07)
Skoda
Octavia II (04-08)

ENGINE CODE: 1.4 FSI
AXU, BKG, BLN
1.6 FSI
BAG, BLF, BLP, BTS

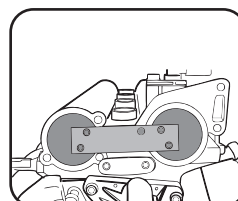
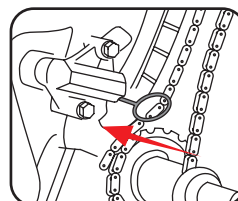

- CONTENTS :
- A - camshaft setting plate
 - B - TDC position tool (with DTI)
 - C - tensioner locking pin

