

Flexible Hose Clamp Pliers

9AA31

- Use to remove and install spring clamp
- Flexible flat jaw with greater access in confined spaces
- Suitable for universal cars

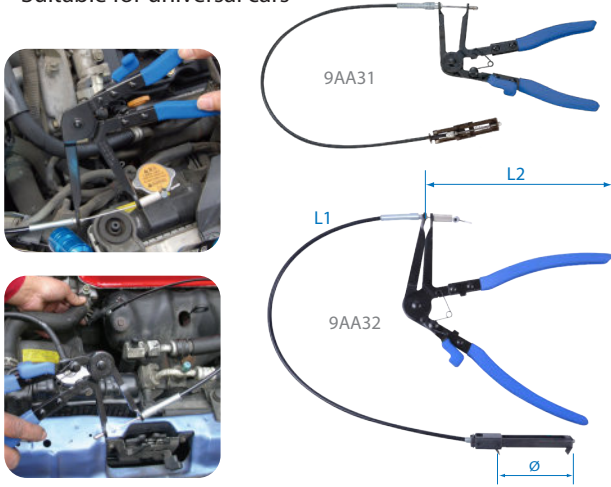

KT NO.	∅ mm	inch	L1 mm	L2 mm	g	kg	Box / Carton
9AA31	53	25	630	9	225	528	12 / 36
9AA32	77	27-1/4	700	12	310	756	6 / 24

CLIC Hose Clamp Pliers

9AA15

- Use to remove and install CLIC and CLIC-R clamp
- Special-designed jaws
- Suitable for VW, Audi, Opel, Citroen, Peugeot, Fiat, Renault, Mercedes-Benz

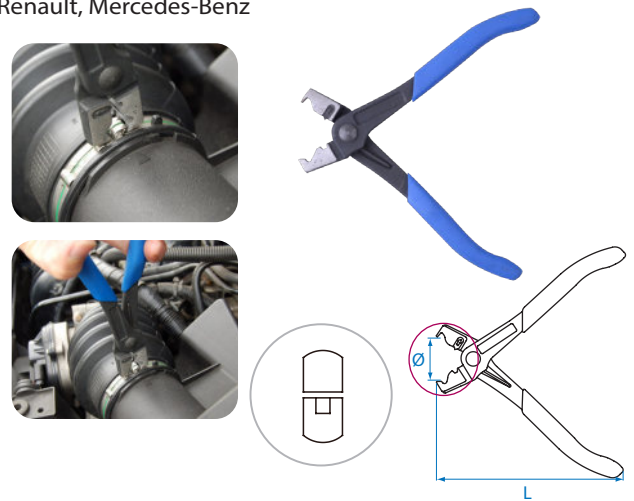

KT NO.	∅ mm	inch	L mm	g	kg	Box / Carton
9AA15	36	5-19/32	142	223		12 / 72

Fuel Line Hose Clamp Pliers

9AA17

- Use to remove and install fuel line clamp
- Special pick jaws
- Suitable for VW, Audi, SEAT, Skoda

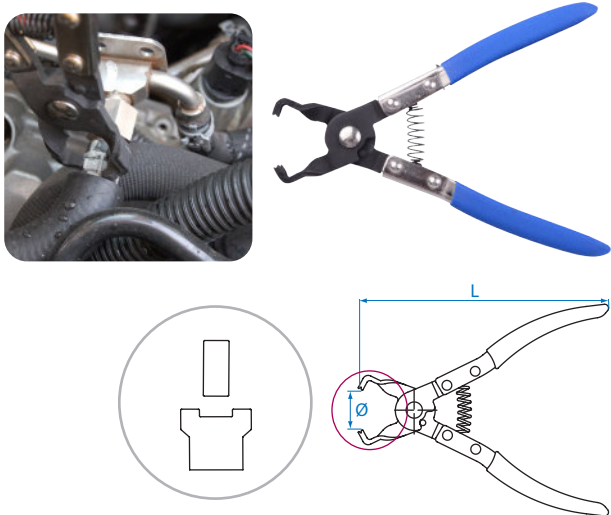

KT NO.	∅ mm	inch	L mm	g	kg	Box / Carton
9AA17	27	6-3/4	171	188		12 / 60

360° CLIC Hose Clamp Pliers

9AA25

- Use to remove and install CLIC and CLIC-R clamp
- 360° swivel angle
- Suitable for VW, Audi, Opel, Citroen, Peugeot, Fiat, Renault, Mercedes-Benz

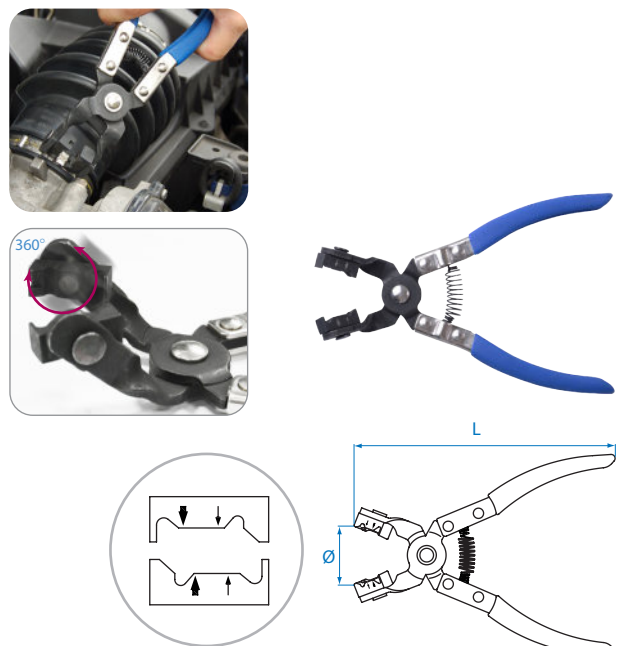

KT NO.	∅ mm	inch	L mm	g	kg	Box / Carton
9AA25	32	7	175	224		12 / 72