

# Gear Puller & Set

- Material - chrome vanadium alloy steel
- Finishing - chrome plated & phosphate sunk

## 7962

- Two-Jaw gear puller

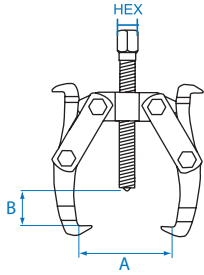

KT NO.	Capacity (tons)	HEX (mm)	Jaw (leg)	Spread (A)mm	Reach (B)mm	Kg	Box	Kit
7962-03	2	14	2	40~75	60	0.44	1 / 40	
7962-04	4	17	2	50~100	95	0.78	1 / 20	
7962-06	6	19	2	70~150	150	1.65	1 / 10	
7962-08	10	23	2	95~200	235	3.50	1 / 5	
7962-12	15	32	2	140~300	280	7.00	1 / 2	

## 7963

- Three-Jaw gear puller

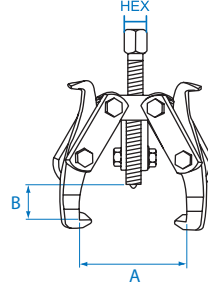

KT NO.	Capacity (tons)	HEX (mm)	Jaw (leg)	Spread (A)mm	Reach (B)mm	Kg	Box	Kit
7963-03	3	14	3	40~75	60	0.55	1 / 40	
7963-04	6	17	3	50~100	95	1.06	1 / 20	
7963-06	9	19	3	70~150	150	2.25	1 / 10	
7963-08	15	23	3	95~200	235	4.50	1 / 5	
7963-12	22	32	3	140~300	280	11.00	1 / 2	

## 7962B

- Two-Jaw gear puller
- Adjustable sliding arm for efficiency and safety
- Reversible jaws for internal & external options gear, axle, bearing, etc...

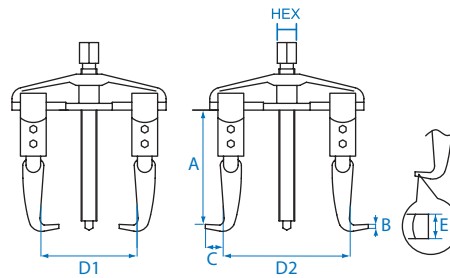
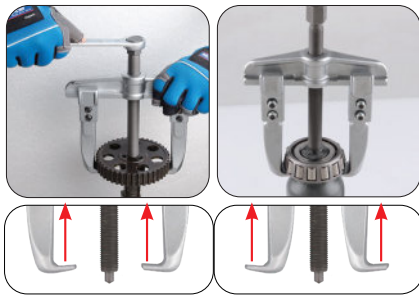

KT NO.	Capacity (tons)	Hex (mm)	Jaw (leg)	Reach A(mm)	B (mm)	C (mm)	Spread D1 (mm)	Spread D2(mm)	E (mm)	Kg	Box	Kit
7962B-35	3.0	17	2	100	3.8	14.5	90	60~125	21	1.05	1/12	
7962B-05	5.0	17	2	100	3.8	14.5	130	60~160	21	1.15	1/12	
7962B-06	5.0	22	2	150	4.6	23.0	150	85~200	30	2.98	1/6	
7962B-08	7.5	22	2	150	4.6	23.0	190	105~230	30	3.41	1/6	
7962B-10	7.5	27	2	210	7.0	30.0	240	130~300	35	7.11	1/3	

## 7962B1PR

- Two-Jaw gear puller
- Adjustable sliding arm for efficiency and safety
- Reversible jaws for internal & external options gear, axle, bearing, etc...



5 PC.

Contents

18.20 Kg

1 Box



7962B 3.5", 5", 6", 8", 10"

87155

## Micro Bearing Puller

### 7965-02

- Applications include: alternators, generators, domestic appliances, power tools and pumps

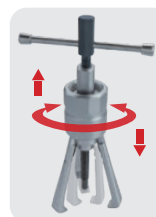

- Adjust the jaws by turning the screw

KT NO.	Capacity (Tons)	Spread A(mm)	Reach B(mm)	Kg	Box	Kit
7965-02	2T	19-45	73	905	1 / 12	