

# Standard Impact Socket

KT No. & D1



## 6515M

3/4"

- Lightweight type
- DIN 3121

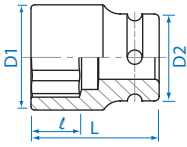

KT NO.	mm	D1 mm	D2 mm	ℓ mm	L mm	g	kg
651514M	14	25.0	38	10	50	206	8 / 96
651515M	15	26.0	38	10	50	210	8 / 96
651516M	16	27.5	38	10	50	216	8 / 96
651517M	17	29.0	38	10	50	228	8 / 96
651518M	18	30.0	38	10	50	232	8 / 96
651519M	19	32.0	38	10	50	241	8 / 96
651521M	21	35.0	38	13	50	254	8 / 96
651522M	22	36.0	38	13	50	260	8 / 96
651523M	23	37.0	38	15	50	261	8 / 96
651524M	24	38.0	38	15	50	265	8 / 96
651525M	25	38.0	38	15	53	275	8 / 96
651526M	26	38.0	38	15	53	259	6 / 48
651527M	27	42.0	38	18	53	311	6 / 48
651528M	28	44.0	38	18	53	332	6 / 48
651529M	29	45.0	38	18	53	345	6 / 48
651530M	30	46.0	38	20	53	348	6 / 48

## 6535M

3/4"

- DIN 3121

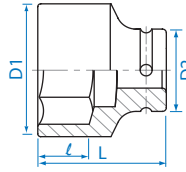

KT NO.	mm	D1 mm	D2 mm	ℓ mm	L mm	g	kg
653513M	13	22.0	38	16	50	205	8 / 96
653517M	17	29.0	44	10	50	309	6 / 48
653518M	18	30.0	44	10	50	314	6 / 48
653519M	19	32.0	44	10	50	323	6 / 48
653521M	21	35.0	44	13	50	336	6 / 48
653522M	22	36.0	44	13	50	340	6 / 48
653523M	23	37.0	44	15	50	339	6 / 48
653524M	24	38.0	44	15	50	343	6 / 48
653526M	26	40.0	44	15	53	364	6 / 48
653527M	27	42.0	44	18	53	379	6 / 48
653528M	28	44.0	44	18	53	390	6 / 48
653529M	29	45.0	44	18	53	399	6 / 48
653530M	30	46.0	44	20	53	349	6 / 48
653531M	31	47.0	44	20	53	413	6 / 48
653532M	32	48.0	44	20	57	456	6 / 36
653533M	33	50.0	44	20	57	481	6 / 36
653534M	34	51.0	44	22	57	488	6 / 36
653535M	35	52.0	44	22	57	499	6 / 36
653536M	36	53.0	44	22	57	508	6 / 36
653538M	38	56.0	44	22	57	553	4 / 32
653540M	40	58.0	44	22	58	590	4 / 32
653541M	41	59.0	44	24	58	584	4 / 32
653542M	42	61.0	44	24	58	622	2 / 24
653543M	43	62.0	44	24	58	638	2 / 24
653544M	44	64.0	44	24	62	706	2 / 24
653545M	45	64.0	44	24	62	704	2 / 24
653546M	46	66.0	44	24	62	730	2 / 24
653548M	48	68.0	44	26	65	807	2 / 24
653550M	50	71.0	44	26	65	870	1 / 20
653552M	52	74.0	54	30	68	1083	1 / 20
653554M	54	76.0	54	30	68	1151	1 / 20
653555M	55	77.0	54	30	70	1196	1 / 20
653557M	57	79.0	54	32	70	1211	1 / 20
653558M	58	81.0	54	32	70	1275	1 / 20
653560M	60	84.0	54	32	70	1424	1 / 20
653563M	63	83.5	54	40	80	1317	1 / 12
653565M	65	85.5	54	43	80	1324	1 / 12
653570M	70	92.0	54	45	83	1571	1 / 12

## 6530M

3/4"

- DIN 3129, ISO 2725-2

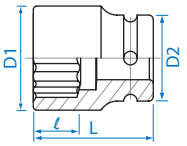

KT NO.	mm	D1 mm	D2 mm	ℓ mm	L mm	g	kg
653017M	17	29.0	44	10	50	319	6 / 48
653019M	19	32.0	44	10	50	322	6 / 48
653021M	21	35.0	44	13	50	333	6 / 48
653022M	22	36.0	44	13	50	335	6 / 48
653023M	23	37.0	44	15	50	335	6 / 48
653024M	24	38.0	44	15	50	338	6 / 48
653026M	26	40.0	44	15	53	360	6 / 48
653027M	27	42.0	44	18	53	361	6 / 48
653028M	28	44.0	44	18	53	384	6 / 48
653029M	29	45.0	44	18	53	387	6 / 48
653030M	30	46.0	44	20	53	390	6 / 48
653032M	32	48.0	44	20	57	440	6 / 36
653033M	33	50.0	44	20	57	476	6 / 36
653034M	34	51.0	44	22	57	479	6 / 36
653035M	35	52.0	44	22	57	488	6 / 36
653036M	36	53.0	44	22	57	489	6 / 36
653038M	38	56.0	44	22	57	534	4 / 32
653040M	40	58.0	44	22	58	577	4 / 32
653041M	41	59.0	44	24	58	573	4 / 32
653042M	42	61.0	44	24	58	610	2 / 24
653046M	46	66.0	44	24	62	723	2 / 24
653063M	63	84.5	54	40	80	1352	1 / 12
653065M	65	86.5	54	43	80	1381	1 / 12
653070M	70	92.0	54	45	83	1445	1 / 12