

Impact Bit Socket Set

3406MP

3/8"

- For hexagon head screw
- 55mmL

Metal case size (mm) :
203 x 79 x 41 (0.023 cuft)

6
PC.



Contents



0.72



1 / 20



3055M

H4, H5, H6, H8, H10, H12

3419PP

3/8"

- For torx internal head
- 55mmL

Metal case size (mm) :
203 x 79 x 41 (0.023 cuft)

9
PC.



Contents



0.62



1 / 20



3053

T10, T15, T20, T25, T27, T30, T40, T45, T50



Standard Impact Socket

KT No. & D1



4530M

1/2"

- DIN 3129, ISO 2725-2

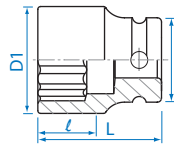

KT NO.	mm	D1 mm	D2 mm	l mm	L mm	g	Box
453008M	8	15.0	25	7	38	65	10 / 200
453009M	9	16.3	25	7	38	68	10 / 200
453010M	10	17.6	25	8	38	68	10 / 200
453011M	11	18.8	25	8	38	69	10 / 200
453012M	12	20.0	25	9	38	73	10 / 200
453013M	13	21.2	25	10	38	71	10 / 200
453014M	14	22.5	25	10	38	78	10 / 200
453015M	15	23.8	30	11	38	111	10 / 160
453016M	16	25.0	30	11	38	118	10 / 160
453017M	17	26.2	30	12	38	116	10 / 160
453018M	18	27.5	30	13	38	115	10 / 160
453019M	19	28.8	30	13	38	114	10 / 160
453020M	20	29.5	30	13	38	117	10 / 160
453021M	21	30.0	30	14	40	121	8 / 160
453022M	22	32.4	30	14	40	129	8 / 160
453023M	23	33.2	30	15	40	130	8 / 160
453024M	24	34.4	30	15	42	147	6 / 120
453025M	25	36.0	30	15	42	164	6 / 120
453026M	26	37.0	30	15	42	168	6 / 120
453027M	27	38.0	30	16	44	170	6 / 120
453028M	28	41.0	30	16	44	205	6 / 120
453029M	29	41.0	30	17	44	184	6 / 120
453030M	30	42.0	30.5	17	44	197	6 / 120
453032M	32	46.0	30	19	44	226	6 / 120
453033M	33	46.0	30	19	46	246	6 / 96
453034M	34	46.0	30	20	46	217	6 / 96
453036M	36	47.0	30	20	46	214	6 / 96
453038M	38	50.0	30	21	50	279	6 / 60
453041M	41	56.0	30	22	52	402	6 / 60

4530S

1/2"

- ANSI / ASME B107.2

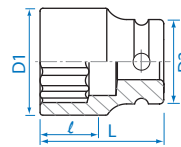

KT NO.	inch	D1 mm	D2 mm	l mm	L mm	g	Box
453016S	1/2	20	25	10	38	72	10 / 200
453018S	9/16	22	25	10	38	76	10 / 200
453020S	5/8	24	25	11	38	78	10 / 200
453022S	11/16	26	30	12	38	116	10 / 160
453024S	3/4	28.8	30	13	38	120	10 / 160
453026S	13/16	30	30	14	40	122	8 / 160
453028S	7/8	32	30	14	40	138	8 / 160
453030S	15/16	34	30	15	42	148	6 / 120
453032S	1	36	30	15	42	162	6 / 120
453034S	1-1/16	38	30	16	44	167	6 / 120
453036S	1-1/8	41	30	17	44	189	6 / 120
453038S	1-3/16	42	30.5	17	44	203	6 / 120